

## Instructions on the Assembly of a diagonal corner wardrobe (Type C)

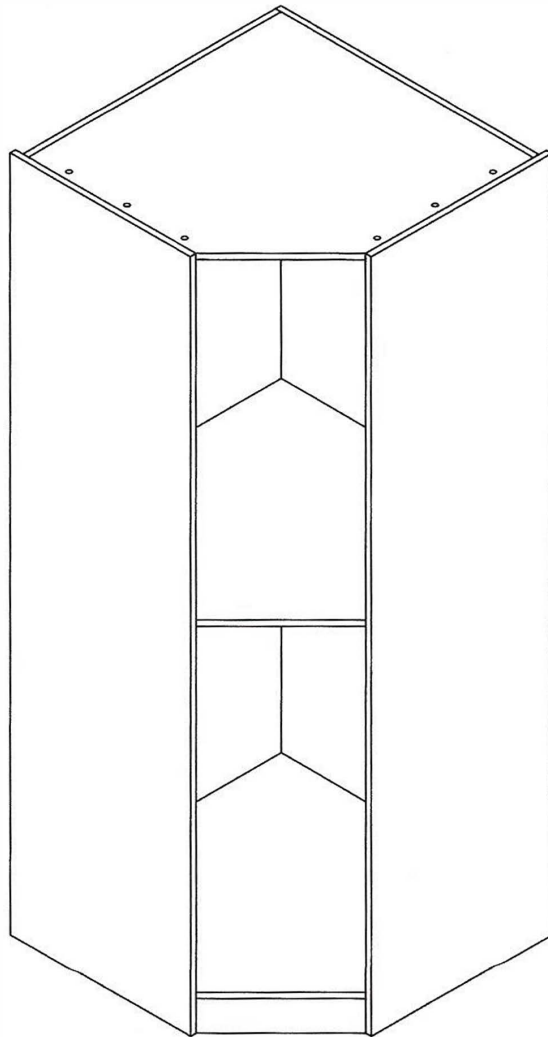

Note: All measurements in mm (millimeters).

Standard height robe is 2155 high, 900x900 wide & 600 deep, 100 high integral plinth. Each robe is supplied with a shelf for a choice of 2 positions or can be disregarded. All robes come with a 25mm void at rear allowing for scribing over skirting boards. All panels are 18mm thick. Door thickness vary per manufacturer.



DIY Homefit Ltd.  
5a Stanhope Gate  
Camberley  
Surrey GU15 3DW  
Phone: 01276 500102  
Fax: 01277 660300  
[www.diyhomefit.co.uk](http://www.diyhomefit.co.uk)

Back panel  
2155x839

Back panel  
2155x857

Fixed top panel  
839 x 839

Intermediate shelf  
839 x 839

Gable end  
2155x600

Plinth rail  
839x100

Plinth rail  
821x100

Base  
839 x 839

Plinth rail  
angled to suit

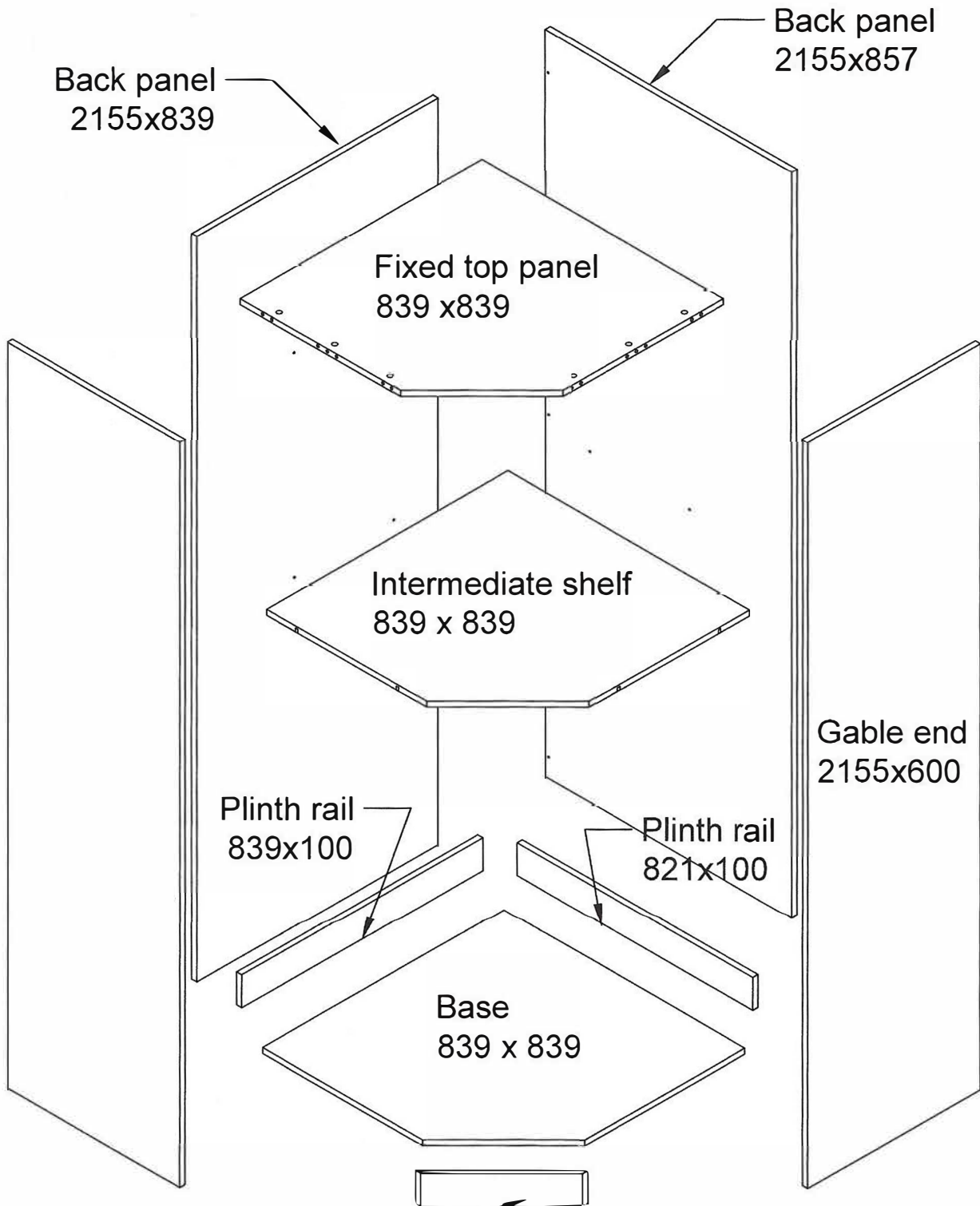

Insert fixings into backs..

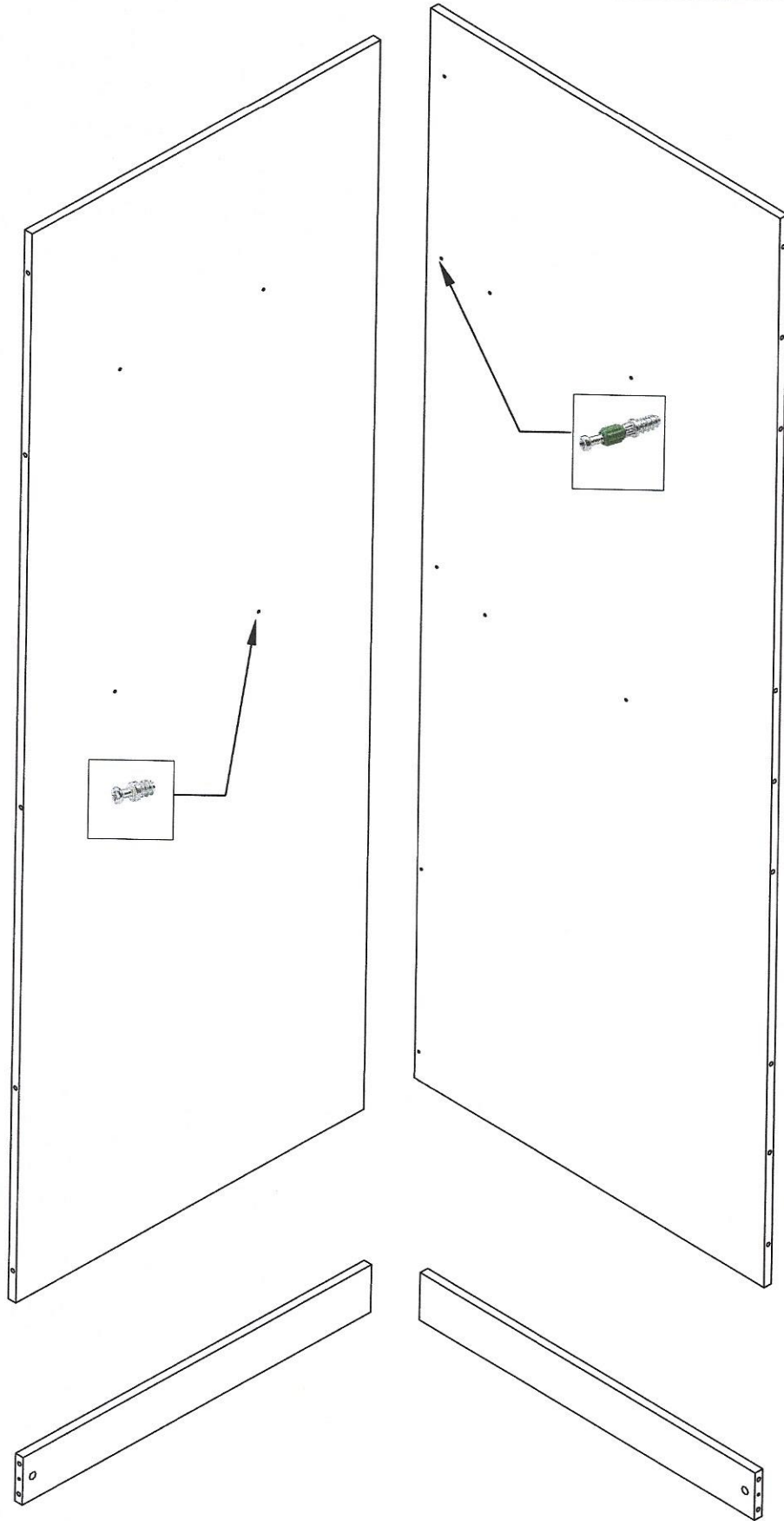

## Assembly Of Corner Robes ( guidance)

### 2 Person Assembly Built Upright

1. First attach all fixings, ie, cams and dowels as per standard robe instructions.
2. Start with the left hand gable first.
3. Attach the 839 wide back to this gable with the cam & dowel.
4. With the second person holding the top, fix into place on the left end with the cam & dowel and then screw through the back into the top keeping it level with the top of back.
5. Attach the 2 backs together now using the cam & dowel and then again screw through the back into the top keeping it level again.
6. Now the right hand gable can be attached with the cam & dowel.
7. Fix the 839 wide rail into position with the cam & dowel at one end and then screw through into the back panel.
8. Same fixings for the 821 wide rail.
9. The front angled rail is fixed from the back, screw through the rail into the robe end.
10. The rest of the assembly for the diagonal corner robe is as per standard robe construction with the exception of the hinge which is a 45dg hinge, this differs to the other standard robe hinges.
11. The hanging rail is made up of 2 rails, a corner piece and 2 supports.

